

# D Series → Model i-FSS-xSHHHH

A standard-height indoor system offering a flexible duct connection pattern and integrated blowers supplying a wide range of pressures and flows. Construction is aluminum space frame with corrosion-resistant hardware and double-walled coated aluminum panels, whose closed-cell foam insulation results in a 6.3 R-value.

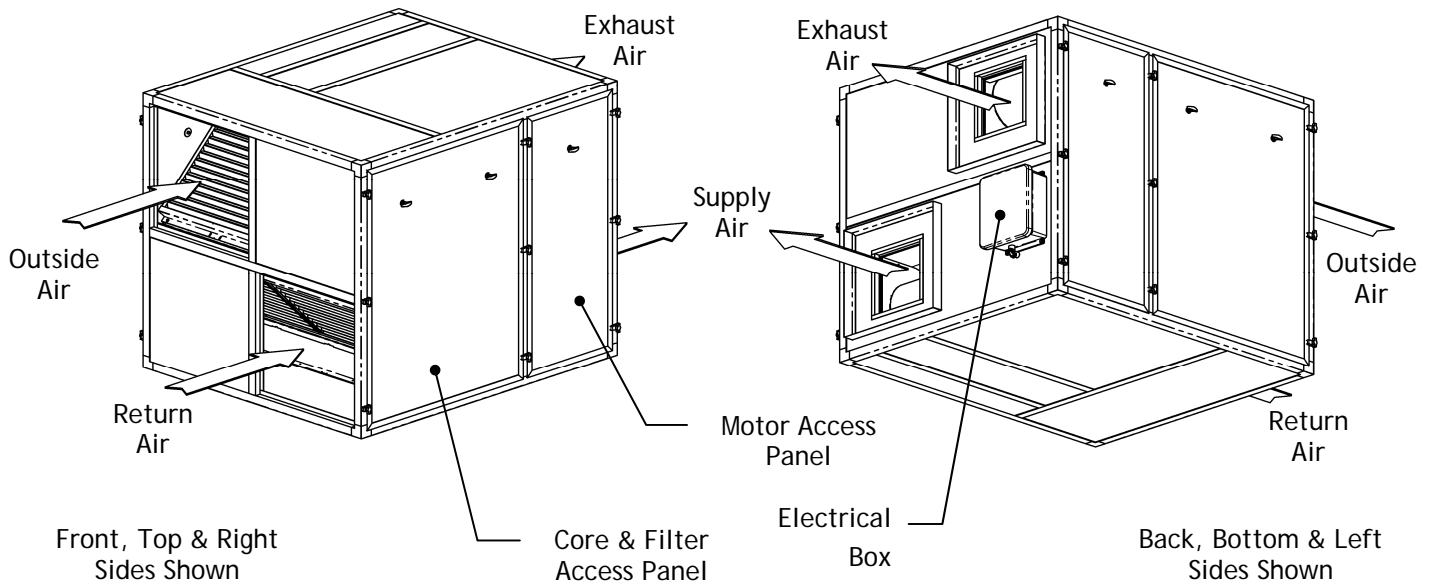

<b>D2i-FSS -xSHHHH</b>	ESP [in-H <sub>2</sub> O]		Max Weight = 367 lb		<b>D3i-FSS -xSHHHH</b>	ESP [in-H <sub>2</sub> O]		Max Weight = 459 lb					
	0	0.5	1	1.5		0	0.5	1	1.5				
	Airflow	600	1/2 hp	1/2 hp		1/2 hp	3/4 hp	Airflow	800	1/2 hp	1/2 hp	3/4 hp	3/4 hp
	[SCFM]	900	1/2 hp	1 hp		1 hp	1.5 hp	[SCFM]	1200	1/2 hp	3/4 hp	1 hp	1.5 hp
		1000	1/2 hp	3/4 hp		1.5 hp	1.5 hp		1500	3/4 hp	1 hp	1.5 hp	2 hp
	1200	1 hp	1 hp	1.5 hp	2 hp		1800	1.5 hp	1.5 hp	2 hp	2 hp		
<b>D4i-FSS -xSHHHH</b>	ESP [in-H <sub>2</sub> O]		Max Weight = 545 lb		<b>D5i-FSS -xSHHHH</b>	ESP [in-H <sub>2</sub> O]		Max Weight = 633 lb					
	0	0.5	1	1.5		0	0.5	1	1.5				
	Airflow	1000	1/2 hp	1/2 hp		3/4 hp	1 hp	Airflow	1500	1/2 hp	3/4 hp	1 hp	1.5 hp
	[SCFM]	1800	1 hp	1.5 hp		1.5 hp	2 hp	[SCFM]	2000	1 hp	1.5 hp	2 hp	2 hp
		2000	1.5 hp	1.5 hp		2 hp	3 hp		2500	1.5 hp	3 hp	3 hp	3 hp
	2400	1.5 hp	3 hp	3 hp	3 hp		3000	3 hp	3 hp	5 hp	5 hp		
<b>D6i-FSS -xSHHHH</b>	ESP [in-H <sub>2</sub> O]		Max Weight = 725 lb		<b>D7i-FSS -xSHHHH</b>	ESP [in-H <sub>2</sub> O]		Max Weight = 835 lb					
	0	0.5	1	1.5		0	0.5	1	1.5				
	Airflow	1800	3/4 hp	1 hp		1.5 hp	1.5 hp	Airflow	2000	3/4 hp	1.5 hp	1.5 hp	2 hp
	[SCFM]	2400	1.5 hp	2 hp		3 hp	3 hp	[SCFM]	3000	2 hp	3 hp	3 hp	3 hp
		3000	2 hp	3 hp		3 hp	5 hp		3500	3 hp	5 hp	5 hp	5 hp
	3400	3 hp	5 hp	5 hp	5 hp		4000	3 hp	5 hp	5 hp	7.5 hp		
<b>D8i-FSS -xSHHHH</b>	ESP [in-H <sub>2</sub> O]		Max Weight = 915 lb		<b>D9i-fss -xSHHHH</b>	ESP [in-H <sub>2</sub> O]		Max Weight = 1003 lb					
	0	0.5	1	1.5		0	0.5	1	1.5				
	Airflow	3000	1.5 hp	3 hp		3 hp	3 hp	Airflow	3500	2 hp	3 hp	3 hp	5 hp
	[SCFM]	3500	2 hp	3 hp		3 hp	5 hp	[SCFM]	4000	3 hp	3 hp	5 hp	5 hp
		4000	3 hp	5 hp		5 hp	5 hp		4500	5 hp	5 hp	5 hp	5 hp
	4500	5 hp	5 hp	5 hp	7.5 hp		5000	5 hp	7.5 hp	7.5 hp	7.5 hp		

# CORES	MODEL #	A	B	C	D
2	D2i - FSS	29.18	26.72	11	10
3	D3i - FSS	41.52	39.06	17.17	15
4	D4i - FSS	53.87	51.41	23.34	21
5	D5i - FSS	66.21	63.75	29.51	27
6	D6i - FSS	78.55	76.09	35.68	33
7	D7i - FSS	90.9	88.44	41.86	39
8	D8i - FSS	103.24	100.78	48.03	45
9	D9i - FSS	115.59	113.13	54.2	51

NOTES:

SYSTEM IS INTENDED FOR INDOOR USE ONLY

OA - OUTSIDE AIR INTAKE  
 SA - SUPPLY AIR EXIT  
 RA - RETURN AIR INTAKE  
 EA - EXHAUST AIR EXIT

OA & RA INPUTS CAN BE SWITCHED UPON REQUEST,  
 CAUSING SA & EA TO REVERSE POSITIONS

D4i-FSS-xSHHHH MODEL PICTURED

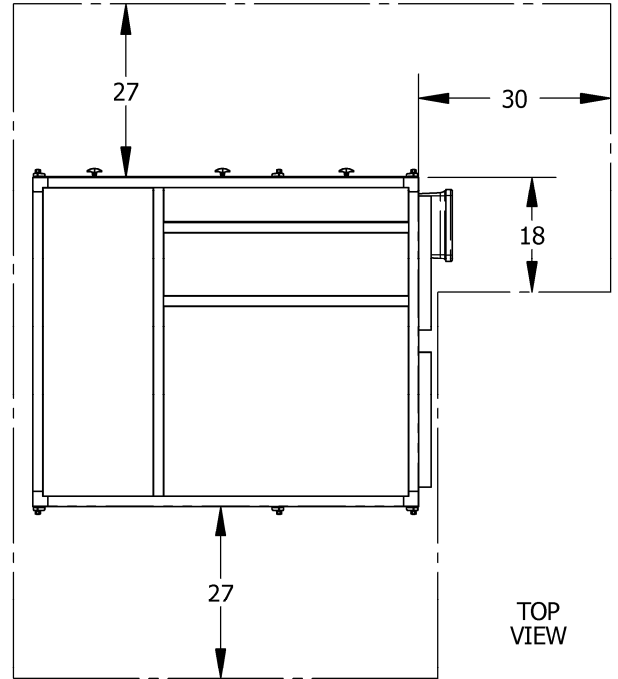
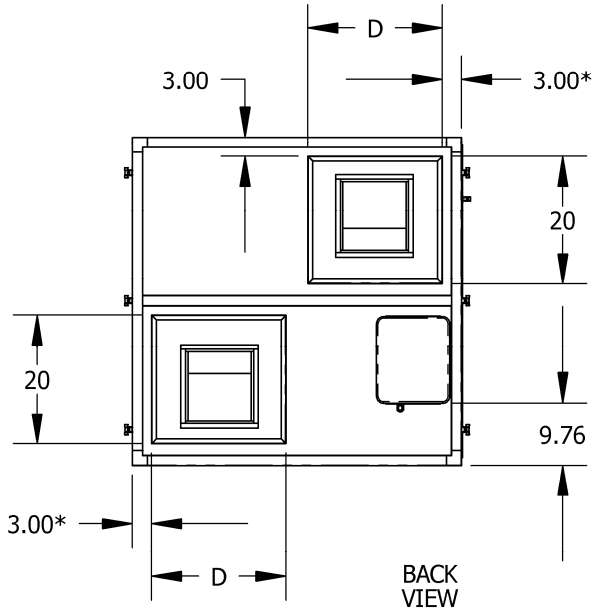

RECOMMENDED SERVICE AREA SHOWN

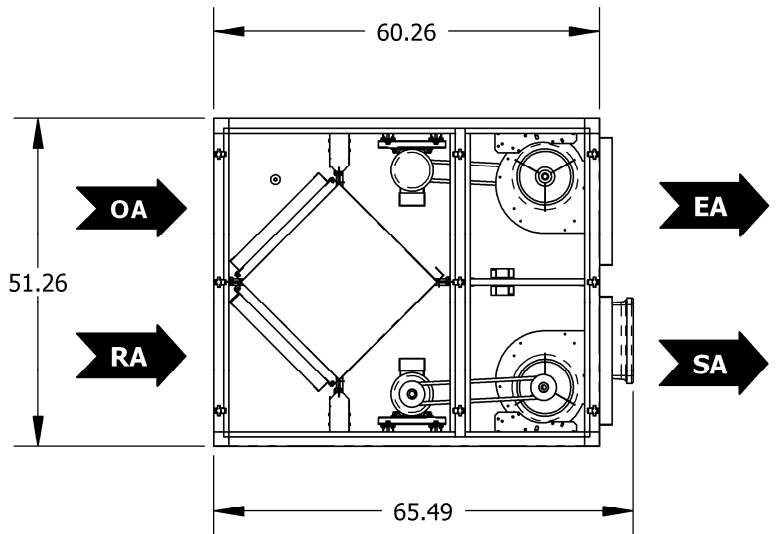
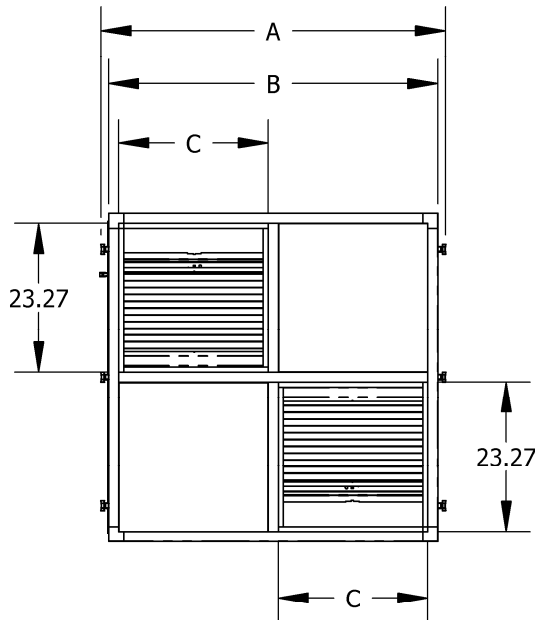

\* THESE DIMENSIONS ARE REDUCED TO 2.00 FOR THE D2i-FSS-xSHHHH MODEL