

# D Series → Model i-FSE-xSHHHH

A standard-height indoor system with extended duct connections and integrated blowers supplying a wide range of pressures and flows. Construction is aluminum space frame with corrosion-resistant hardware and double-walled coated aluminum panels, whose closed-cell foam insulation results in a 6.3 R-value.

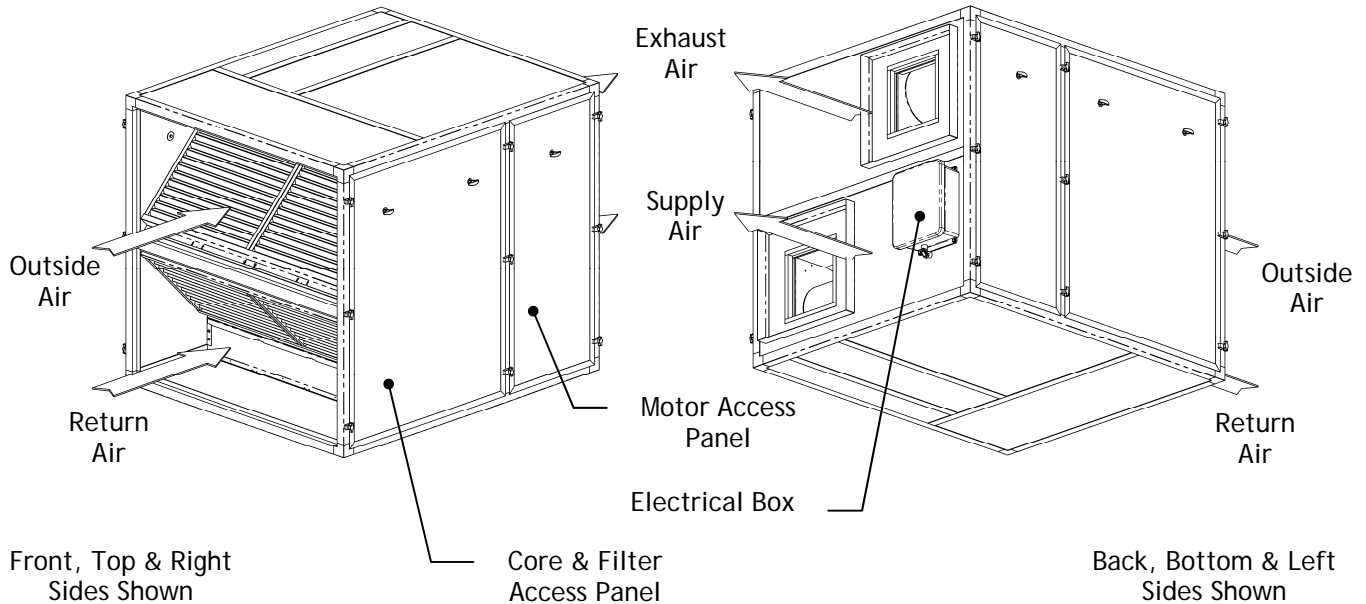

<b>D2i-FSE -xSHHHH</b>		ESP [in-H2O]				Max Weight = 358 lb		<b>D3i-FSE -xSHHHH</b>		ESP [in-H2O]			
		0	0.5	1	1.5					0	0.5	1	1.5
Airflow	500	1/2 hp	1/2 hp	1/2 hp	1/2 hp	Airflow	800	1/2 hp	1/2 hp	3/4 hp	3/4 hp		
[SCFM]	900	1/2 hp	1/2 hp	1 hp	1.5 hp	[SCFM]	1200	1/2 hp	3/4 hp	1 hp	1.5 hp		
	1000	1/2 hp	3/4 hp	1.5 hp	1.5 hp		1500	3/4 hp	1 hp	1.5 hp	1.5 hp		
	1200	3/4 hp	1 hp	1.5 hp	1.5 hp		1800	1 hp	1.5 hp	2 hp	2 hp		

<b>D4i-FSE -xSHHHH</b>		ESP [in-H2O]				Max Weight = 532 lb		<b>D5i-FSE -xSHHHH</b>		ESP [in-H2O]			
		0	0.5	1	1.5					0	0.5	1	1.5
Airflow	1000	1/2 hp	1/2 hp	3/4 hp	3/4 hp	Airflow	1500	1/2 hp	3/4 hp	1 hp	1.5 hp		
[SCFM]	1800	3/4 hp	1 hp	1.5 hp	2 hp	[SCFM]	2000	3/4 hp	1 hp	1.5 hp	2 hp		
	2000	1 hp	1.5 hp	1.5 hp	2 hp		2500	1 hp	1.5 hp	2 hp	3 hp		
	2400	1.5 hp	2 hp	3 hp	3 hp		3000	2 hp	3 hp	3 hp	5 hp		

<b>D6i-FSE -xSHHHH</b>		ESP [in-H2O]				Max Weight = 708 lb		<b>D7i-FSE -xSHHHH</b>		ESP [in-H2O]			
		0	0.5	1	1.5					0	0.5	1	1.5
Airflow	1800	1/2 hp	3/4 hp	1.5 hp	1.5 hp	Airflow	2000	1/2 hp	1 hp	1.5 hp	1.5 hp		
[SCFM]	2400	1 hp	1.5 hp	2 hp	3 hp	[SCFM]	3000	1.5 hp	2 hp	3 hp	3 hp		
	3000	1.5 hp	2 hp	3 hp	3 hp		3500	2 hp	3 hp	3 hp	5 hp		
	3400	2 hp	3 hp	5 hp	5 hp		4000	3 hp	3 hp	5 hp	5 hp		

<b>D8i-FSE -xSHHHH</b>		ESP [in-H2O]				Max Weight = 872 lb		<b>D9i-FSE -xSHHHH</b>		ESP [in-H2O]			
		0	0.5	1	1.5					0	0.5	1	1.5
Airflow	3000	1.5 hp	1.5 hp	3 hp	3 hp	Airflow	3500	1.5 hp	2 hp	3 hp	5 hp		
[SCFM]	3500	2 hp	2 hp	3 hp	5 hp	[SCFM]	4000	3 hp	3 hp	5 hp	5 hp		
	4000	3 hp	3 hp	5 hp	5 hp		4500	3 hp	5 hp	5 hp	5 hp		
	4500	5 hp	5 hp	5 hp	5 hp		5000	7.5 hp	5 hp	5 hp	7.5 hp		

# CORES	MODEL #	A	B	C	D
2	D2i - FSE	29.18	26.72	23.57	10
3	D3i - FSE	41.52	39.06	35.91	15
4	D4i - FSE	53.87	51.41	48.26	21
5	D5i - FSE	66.21	63.75	60.60	27
6	D6i - FSE	78.55	76.09	72.94	33
7	D7i - FSE	90.9	88.44	85.29	39
8	D8i - FSE	103.24	100.78	97.63	45
9	D9i - FSE	115.59	113.13	109.98	51

NOTES:

SYSTEM IS INTENDED FOR INDOOR USE ONLY

OA - OUTSIDE AIR INTAKE  
 SA - SUPPLY AIR EXIT  
 RA - RETURN AIR INTAKE  
 EA - EXHAUST AIR EXIT

OA & RA INPUTS CAN BE SWITCHED UPON REQUEST,  
 CAUSING SA & EA TO REVERSE POSITIONS

D4i-FSE-xSHHHH MODEL PICTURED

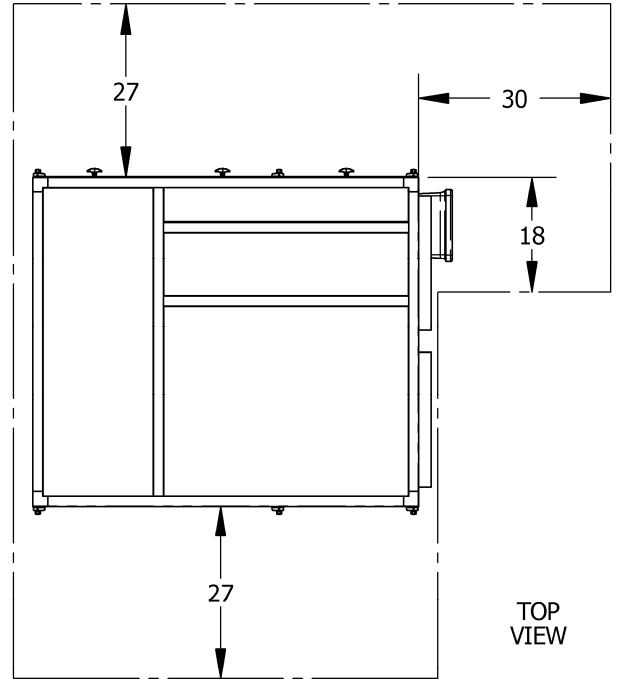
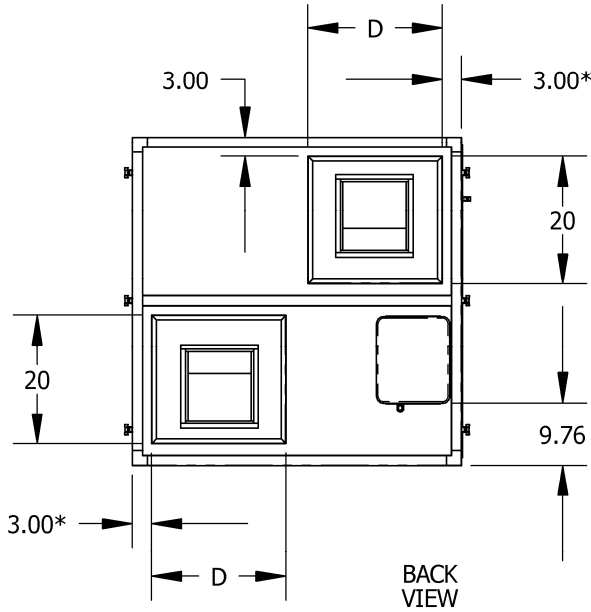

RECOMMENDED SERVICE AREA SHOWN

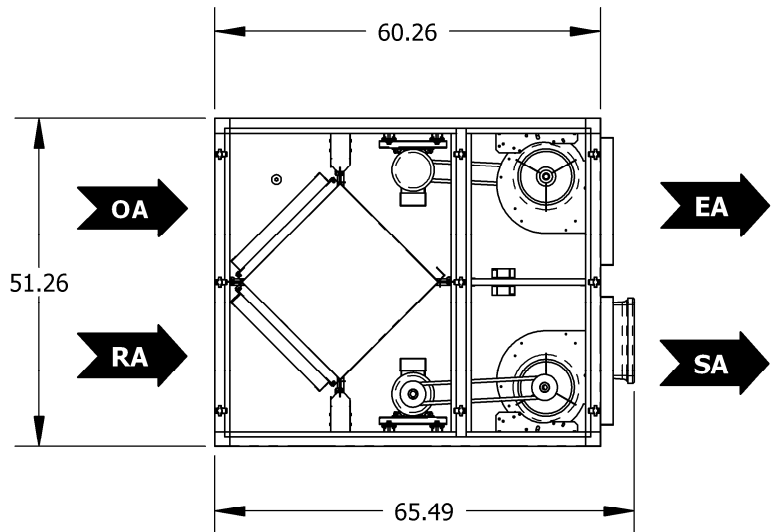
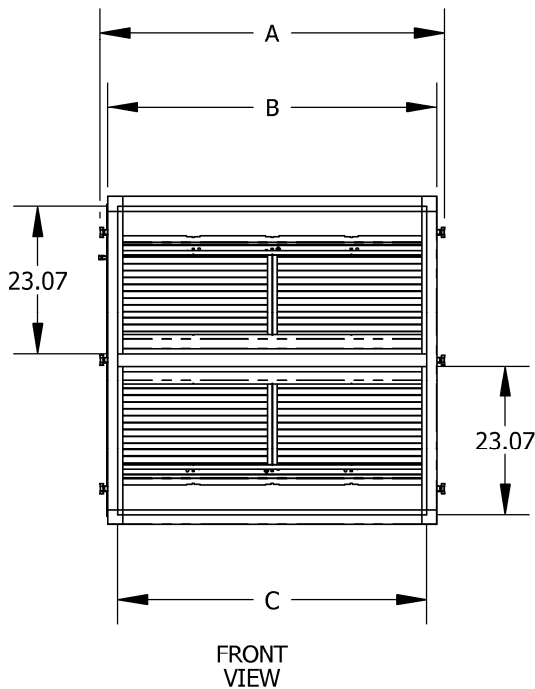

\* THESE DIMENSIONS ARE REDUCED TO 2.00 FOR THE D2i-FSS-xSHHHH MODEL